

PAE LIVING BUILDING

SW 1ST AVENUE & SW PINE STREET



THE LIVING BUILDING CHALLENGE

ARE YOU UP FOR IT?

COMPLETED 2021

The world's first developer-driven Living Building - showcasing Portland as a leader in sustainability and design. This project is carbon neutral and seeks to achieve the highest levels of building performance and sustainability based on modern design and construction methodologies, including Level 4 seismic, while thoughtfully incorporating characteristics of Skidmore Old Town Historic District.

LIVING BUILDINGS ARE REGENERATIVE AND CONTRIBUTE POSITIVELY TO SOCIETY

STRUCTURE

50% regional materials - selected to maximize health & sustainability



PLACE

Designed for people - utilizing urban agriculture



WATER

Supplied by captured rain and re-used water



ENERGY

Generated via photovoltaics



HEALTH & HAPPY

Fresh air & daylight are provided to all



EQUITY

Creating & promoting an inclusive sense of community



BEAUTY

Design features to educate & aesthetically celebrate cultures, spirit & place

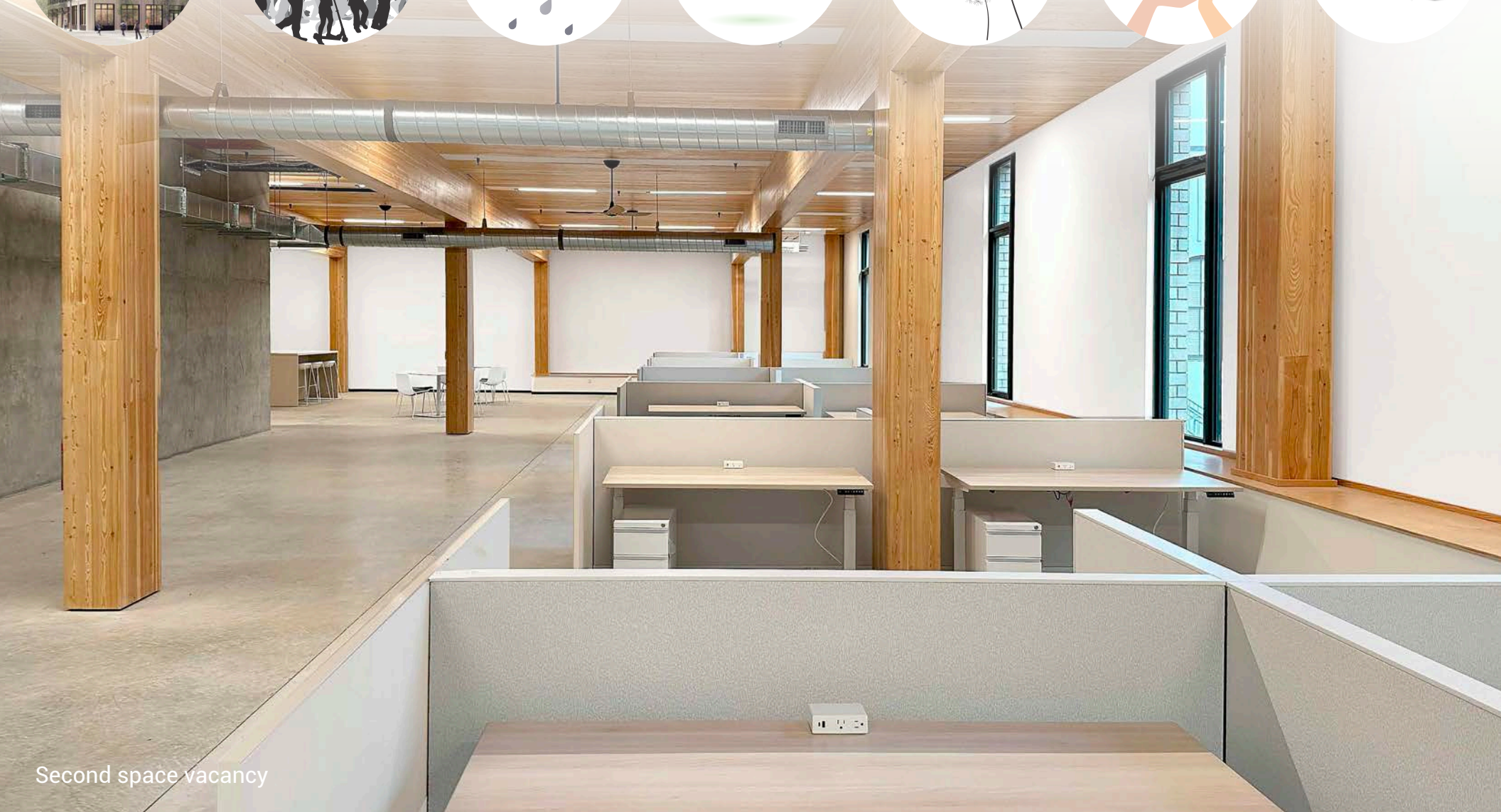
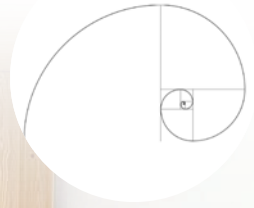

Second space vacancy

2ND FLOOR CREATIVE OFFICE ± 6,106 RSF AVAILABLE

Spec suite improvements underway for move-in ready office space:

- Open collaborative layout
- Kitchenette and lounge
- Conference room
- Expansive ceiling heights
- Abundant glass lines and operable windows
- Exposed timber
- Shared restrooms
- Elevator served

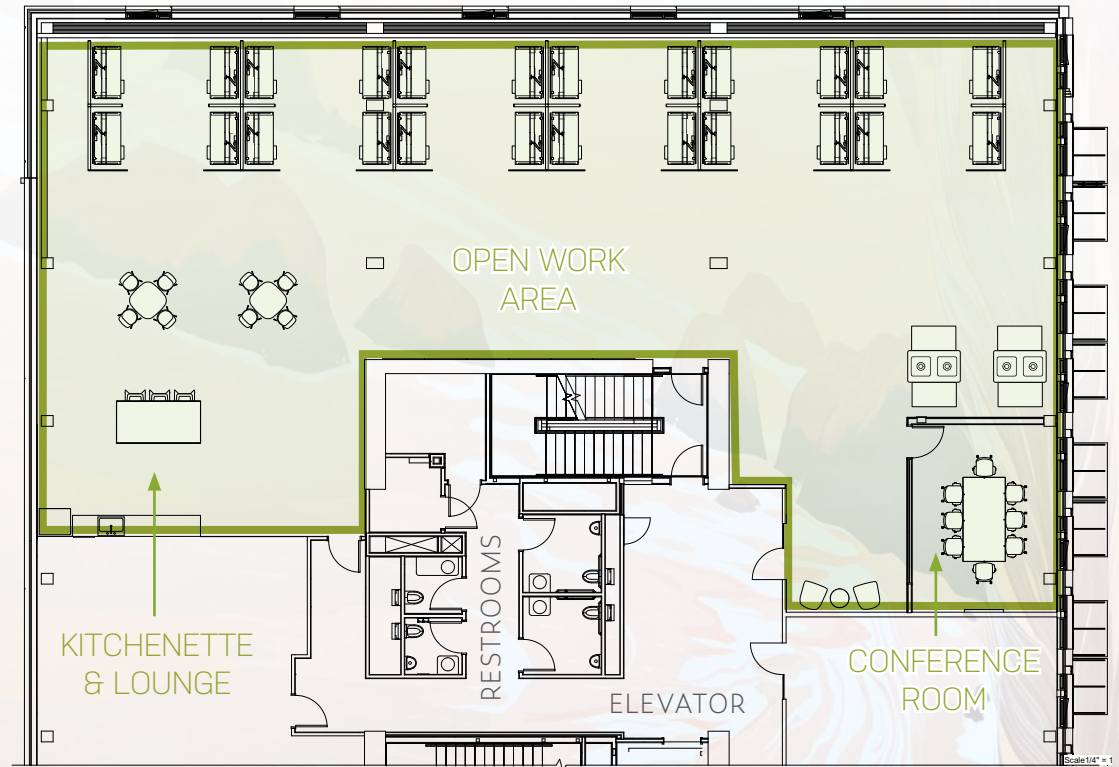

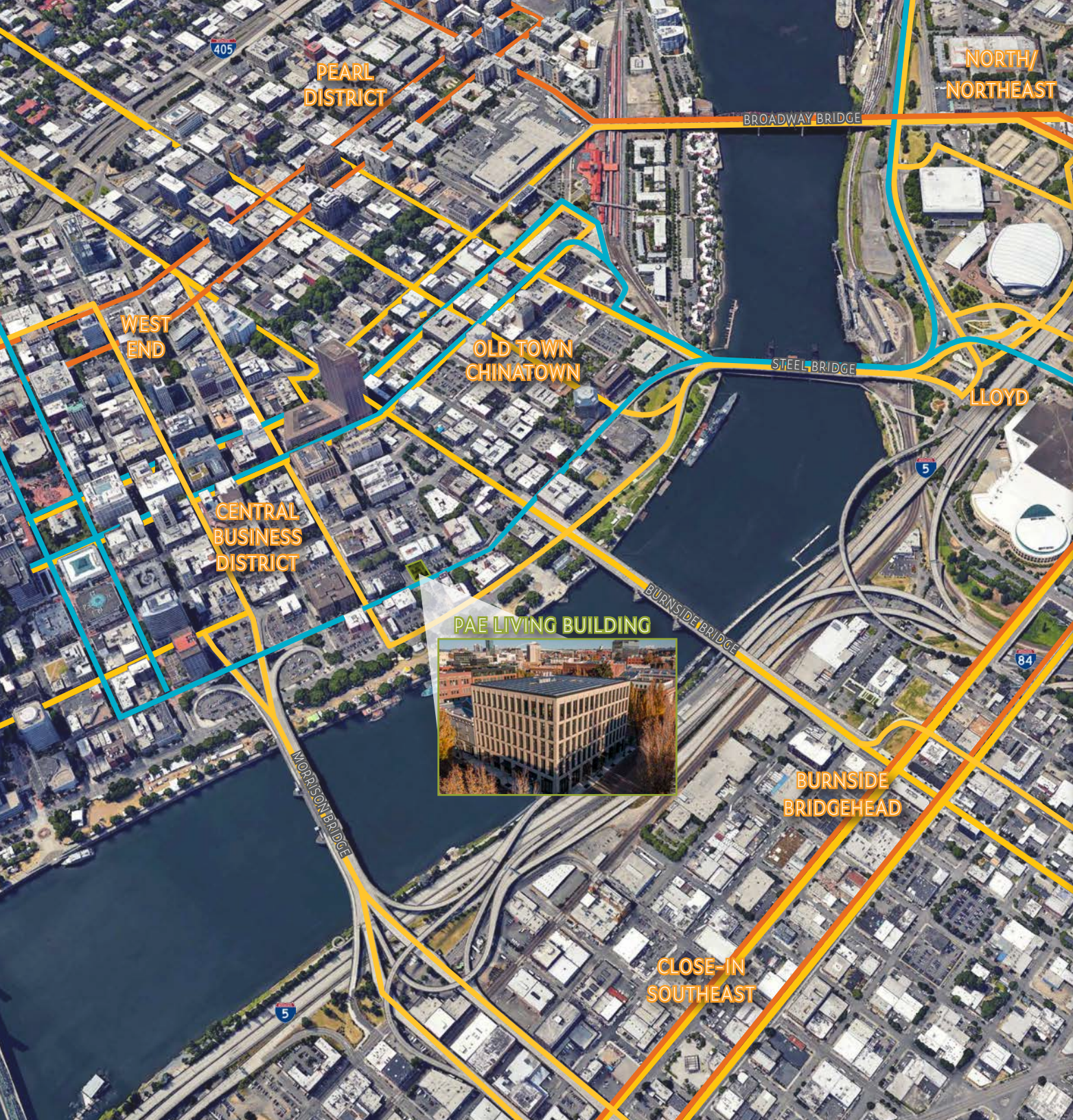



PORTLAND IS THE CENTER FOR ACCESSIBILITY

The Living Building is centrally located with proximity to downtown amenities, Pearl District, Old Town Chinatown and Eastside.



A variety of transit options are easily accessible with TriMet bus lines, MAX, Portland Streetcar and Portland's intricate matrix of bike and pedestrian paths.

AMENITIES



6 block radius

- Over 100 restaurants, cafés & food carts 
- Over 150 retailers 
- Over 13,000 parking stalls 

PUBLIC TRANSIT

- TriMet MAX 
- TriMet Bus 
- Portland Streetcar 

CONVENIENCE

- Walk Score 99  Walker's Paradise
- Transit Score 95  Rider's Paradise
- Bike Score 99  Biker's Paradise



EDLEN & CO.



Nathan Sasaki
Executive Director
503.595.2843
Nathan@apexcre.com

415 NW 11th Avenue
Portland, OR 97209
p. 503.595.2840 / www.apexcre.com
Minority Business Enterprise (MBE) #10272

